

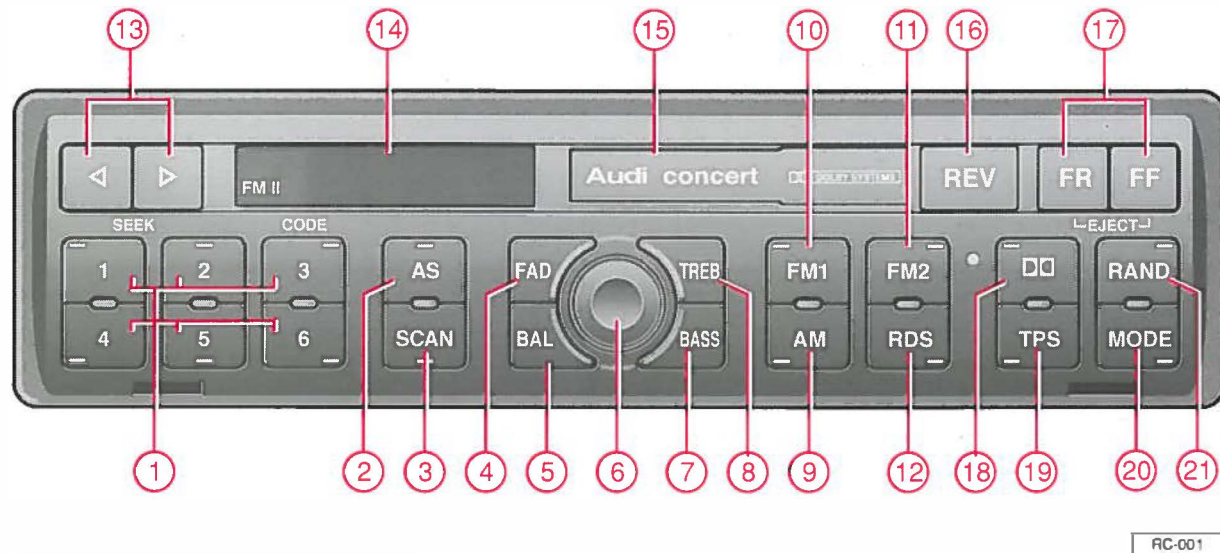

Audi

Concert Sound System





RC-001

Radio code: 1927

	page		page		page
① - Station buttons for 12 FM and 6 AM stations	4	⑩ - FM 1 button: FM waveband	7	⑱ - Dolby® button: When playing cassettes recorded with Dolby®, press this button.	13
- CD selection button	15	⑪ - FM 2 button: FM waveband	7	⑲ - TPS button: To fast forward to the next song	14
② - AS button (Auto Store)	5	⑫ - RDS button:	8	⑳ - MODE button: Changing modes	15
③ - SCAN-button	5	Press the RDS button to switch it on or off.		㉑ - RAND button:	16
④ - FAD-button (Fade control) ...	6	⑬ - Station search and manual tuning buttons	9	Random play for CD. Tracks on CD are played in random order.	
⑤ - BAL-button (Balance control)	6	⑭ - Display	10		
⑥ - On / off, Volume control	6	⑮ - Cassette slot	12		
Note: The unit is equipped with an anti-theft system. If the unit does not work after you switch it on and the word "SAFE" appears in the display, then the radio is locked up. See page 20 for what to do.		⑯ - Cassette side change-over button	12		
⑦ - BASS-button (Bass control) .	7	⑰ - Fast forward and rewind buttons	13		
⑧ - TREB-button (Treble control)	7	- Cassette eject: Press both buttons for longer than 2 seconds	13		
⑨ - AM button: AM waveband	7	- CD Track selection button	16		

©Dolby noise reduction is manufactured under licence by Dolby Licensing Corporation. Dolby and the double D symbol are trademarks of Dolby Laboratories Licensing Corporation.

Introduction

This instruction booklet describes the "Concert" radio, the CD Changer and the BOSE Sound System.

The radio system makes it possible to select between radio, cassette or CD with the minimum number of controls.

The CD Changer is "remote controlled" by the radio unit.

The magazine can hold up to 6 discs.

Because of this, a great number of individual tracks are available for your listening pleasure.

The BOSE Sound System consists mainly of an enlarged speaker system for optimum sound quality.

The system does not require any special operation.

Contents

	Page
Brief Operating Instructions	2
Important Information	3
Radio operation	4
Cassette player	12
CD Player	15
Anti-theft coding	20
Warranty	22
Technical Description	23
Index	29

Please detach the "Radio-Card" and keep it in a safe place away from your vehicle.

or longer
..... 13
n button 16

©Dolby noise reduction is manufactured under licence by Dolby Licensing Corporation. Dolby and the double D symbol are trademarks of Dolby Laboratories Licensing Corporation.

Important information

Operating the radio system when driving

Driving on today's roads demands the full attention of the driver.

The wide range of sophisticated equipment details of modern car radios offer not only a vast source of entertainment but also important information regarding traffic updates, road conditions etc.

But remember, you should only operate the radio system with its numerous features when the traffic situation really allows.

For example, changing a cassette or reading the song titles on a cassette case when driving is often the cause of auto accidents.

You should also set the volume of your radio system so that you can hear signals from other drivers at any time.

Always give your full attention to your driving and traffic conditions!

Anti-theft coding

The anti-theft coding is an electronic means to prevent the radio from being used by unauthorized persons after being removed from the vehicle.

If "SAFE" appears in the display after switching the radio on, it can then only be operated again after entering the **correct** code – see page 20.

The radio code number and the radio serial number can be found on the "Radio Card" next to the table of contents at the beginning of this instruction booklet.

It is very important that you detach this card and keep it in a safe place – never keep it in the vehicle. This is the only way to ensure that your radio is useless to thieves.

CD changer

You can also operate your Audi CD changer* via the radio controls.

How to operate the CD-changer is described on page 18.

* Available as factory installed equipment. Retrofitting should be performed by an authorized Audi dealership.

Radio operation



MODE button 20

Operating mode selection

Use the MODE button to select radio, cassette¹⁾ or CD.

The selection occurs in this sequence: radio – cassette – CD – radio etc.

¹⁾ Only with a cassette fully inserted

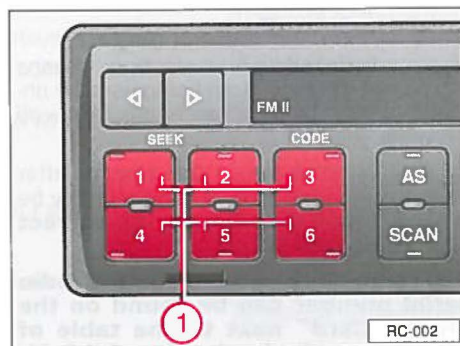

1 – Station buttons

Station buttons

Twelve FM stations can be preset on these six buttons in two series. Press the FM 1 or the FM 2 button to select which series you want.

The selected series is indicated in the display.

Along with the FM stations stored, one AM station can be assigned to each station button.

Storing a station:

First, select the radio station you want to store. Then, press and hold the button long enough until the sound goes off. The display will show the radio frequency and then the station name (call letters).

If a radio station is stored without RDS function, then only the radio frequency will appear in the display. (RDS function – please refer to index for more details)

When a radio station has been correctly stored, the red LED light in station button will light up to confirm that the radio station has been stored.

To listen to a radio station you've stored, simply touch the station button.

Note

Press the station button **only briefly** otherwise the currently displayed frequency will be stored.

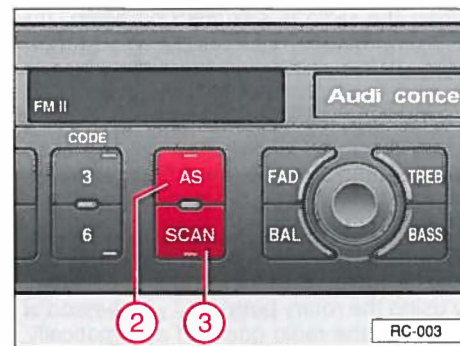

2 – AS button (Auto store)

The AS function makes it possible to automatically store the strongest AM or FM radio stations along with the radio stations you've already stored on the station buttons. This is especially useful when you may be on a trip and are no longer within range receive one of your "favorite" stations.

This is how to use the AS button:

- Press the AM or FM1 (or FM2) button.
- Tap the AS button – AS-STORE appears in the display and the red LED light in the button comes on.

The 6 or 12 strongest local AM or FM stations are now in memory on button locations 1 – 6 (plus 6 FM stations more in the second series FM2). The strongest radio station is stored on storage location 1, the second strongest on storage location 2, etc.

- After completing this storage procedure, the radio automatically selects the strongest station (storage location 1).

By tapping the AS button 1 again, you can automatically recall these 6 or 12 stored radio stations.

- Tap the AS button again, and you can go back to the previous storage level (red LED light goes out).

3 – SCAN button

Tap the button (red LED light comes on) – all available radio stations are shown for eight seconds.

Tap the button again to stop the SCAN. You can now listen to the radio station that is tuned in.

If, in the radio "mode", the station at which the SCAN operation was interrupted is stored, the red diode light lights up under the station button.

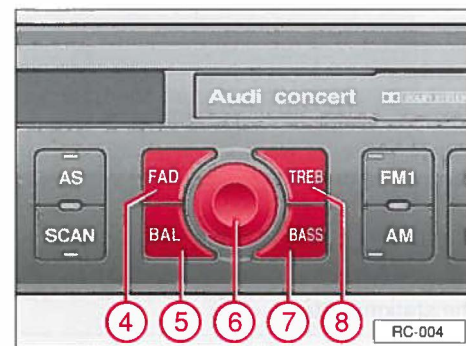

④ – Fader control¹⁾

- Tap the FAD button – “FAD” appears in the display.
 - Adjust the front/ rear speakers by turning the controller ⑥.
- After 5 seconds, the normal display appears again.

⑤ – Balance control

Starting from the middle position (display: BAL 0), adjust the left / right speakers as desired.

- Press the BAL button – “BAL” appears in the display.
- Adjust the left / right speakers by turning the controller ⑥.

After 5 seconds, the normal display appears again.

⑥ – ON / OFF knob, volume control

Normally the radio is switched on via the ignition key – that is – the radio is controlled by the ignition. If you switch off the ignition while the radio is turned on, the radio shuts off automatically. When you switch on the ignition, the radio comes on again.

If necessary, the radio can also be switched on or off by pushing the rotary knob.

When the radio is switched on again, the volume previously set comes on automatically. If the volume is too high, you can lower it to another setting (see page 10) in the menu.

When the radio is switched on, the automatic antenna*, will extend. The frequency tuned in before the radio was last switched off will be received.

With the ignition switched off, you can still turn on the radio for approx. one hour by using the rotary button ⑥. At the end of one hour, the radio goes off automatically. This procedure can be repeated as often as desired.

If the radio does not emit any sound when it is switched on and “SAFE” is displayed, it has been electronically locked up. See page 20 for instructions.

Volume control

Adjust the volume by turning the controller ⑥.

*where applicable

⑦ – Bass control

Starting from the center position (display: BAS 0), raise or lower the bass as desired.

- Press the BASS button – “BAS” appears in the display.
- Adjust the tone by turning the controller ⑥.

After 5 seconds, the normal display appears again.

⑧ – Treble control

Starting from the center position (display: TRE 0), raise or lower the treble as desired.

- Press the TREB button – “TREB” appears in the display.
- Adjust the tone by turning the controller ⑥.

After 5 seconds, the normal display appears again.

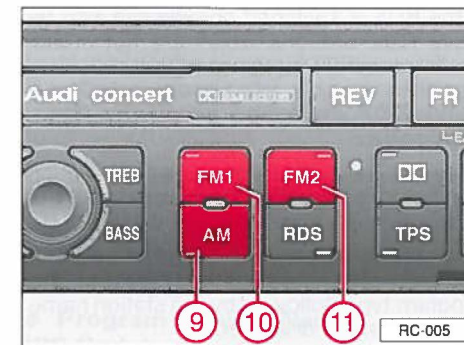

⑨ – AM button

Press this button to select the AM waveband.

The red LED light in the AM button comes on.

All tuner functions, station search, stations stored etc. are then related to the AM waveband.

⑩ – FM 1 button

⑪ – FM 2 button

Tap one of these buttons to select the desired series for the desired radio station buttons. The red LED light in the button comes on as a confirmation.

The selected level is indicated in the display by “FM I” or “FM II”.

All tuner functions, station search, stations stored etc. are then related to the FM waveband.

¹⁾ On the Audi TT with BOSE-SOUND-SYSTEM, FAD OFF will appear in the display. The Fade feature is then de-activated.

Manual tuning

Push the right or left button for longer than two seconds. It is now possible to select the stations manually in the desired direction. Even weaker stations can be set and stored where the search function does not stop.

- Press button briefly – frequency setting changes incrementally (increments of 200 kHz in FM and 10 kHz in AM).
- Press button and hold down – frequency setting changes rapidly. The radio is muted as long as the button is kept depressed.

Note

The radio switches back automatically to the normal station search function approximately 10 seconds after manual tuning.

If one of the selected stations is already stored on one of the station buttons, a red LED below the relevant button comes on or flashes.

14 – Display

Sometime in the display, (see page 1), the "mode" being operated is shown, for example: RDS, radio station frequencies, FM I or FM II, radio station names (call letters), etc. Each are described in this booklet.

Additional functions:**Speed sensitive volume control (GALA)**

- Press and hold the FM2 button and turn on the radio. "GALA" appears in the display.
- Louder = turn the rotary knob ⑥ to the right.
- Quieter and / or off = turn the knob ⑥ to the left (display: "GALA 0")

Changing the "turn on" volume

- Press the hold the FM 2 button and turn on the radio. "GALA" appears in the display.
- Tap the FM 2 button until "VOL" appears in the display.
- Louder = turn rotary knob ⑥ to the right.
- Quieter = turn the rotary knob ⑥ to the left.

Changing the station scan sensitivity

- Press and hold the FM 2 button and turn on the radio. "GALA" appears in the display.
- Tap the FM 2 button until "SENS" appears in the display.
- DX = turn the rotary knob ⑥ to the right.
- LO = turn the rotary knob ⑥ to the left.

Listening to the radio while fast forwarding or rewinding a cassette (radio monitoring)

- Press and hold the FM 2 button and turn on the radio. "GALA" appears in the display.
- Tap the FM 2 button until "RM" appears in the display.
- ON = turn the rotary knob ⑥ to the right.
- OFF = turn the rotary knob ⑥ to the left.

Changing the volume of navigation broadcasts

- Press and hold the FM 2 button and turn on the radio. "GALA" appears in the display.
- Tap the FM 2 button until "NAV" appears in the display.
- Louder = turn rotary knob ⑥ to the right.
- Quieter = turn the rotary knob ⑥ to the left.

Hands-free speaker (with telephone system) left or right¹⁾

- Press and hold the FM 2 button and turn on the radio. "GALA" appears in the display.
- Tap the FM 2 button until "TEL" appears in the display.
- R = turn rotary knob ⑥ to the right.
- L = turn the rotary knob ⑥ to the left.

Note

Starting from the GALA setting, you can jump to the next function by pushing the FM 2 button.

¹⁾ This function is not available on vehicles with the BOSE Sound System.

Cassette player

To play a cassette, the radio must first be switched on and a cassette then inserted into the cassette slot (15). When a cassette is playing, "TAPE" appears in the display.

Dolby Noise Reduction®

Press button (18) to play cassettes with Dolby Noise Reduction.

The red LED light in the button comes on.



MODE-button (18)

Selecting

Use the MODE button to select radio, cassette¹⁾ or CD mode*.

- The selection occurs in sequence: radio – cassette – CD* – radio etc.

If you insert a cassette while the radio or CD* are playing, the unit will automatically switch over to the cassette mode.

¹⁾ Only with fully inserted cassette

® Dolby noise reduction is manufactured under licence by Dolby Licensing Corporation. Dolby and the double D symbol are trademarks of Dolby Laboratories Licensing Corporation.



(15) – Cassette slot

Fully insert cassette into slot with exposed side of tape facing to the right.

(16) – Cassette side change-over button

Press button to change over to other side of tape.

The arrow in the display indicates which side is being played.

If the cassette player suddenly begins playing the other side of the tape during a selection, it might be because the tape does not spool easily enough.

This may be remedied by winding the tape backwards and forwards a few times.

This cassette player features auto-reverse. When it reaches the end of the tape, it automatically switches to the other side and begins playback.

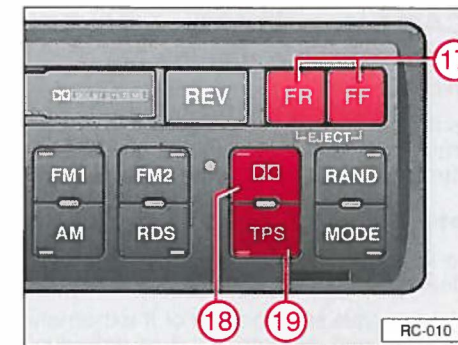

(17) – Buttons for fast forward / rewind and cassette eject

Fast forward and rewind / reverse

(Only possible if "TPS" function is switched off.)

- Push fast forward or rewind button briefly to lock in rapid winding – fast tape run

Winding direction:

The direction of winding is indicated in the display:

> – Fast forward

< – Fast rewind/reverse

End fast forward or rewind by pressing any of the fast running buttons.

When the tape reaches the end, the unit automatically begins playing the other side.

Cassette eject

Press both buttons (17) at the same time to eject a cassette when it is being played. The cassette is ejected automatically.

(18) – Dolby® button

Reduces the noise when playing a cassette. When playing cassettes recorded with Dolby® noise reduction the reproduction quality of the cassette will be significantly improved.

Press button briefly. The red LED in the button will come on.

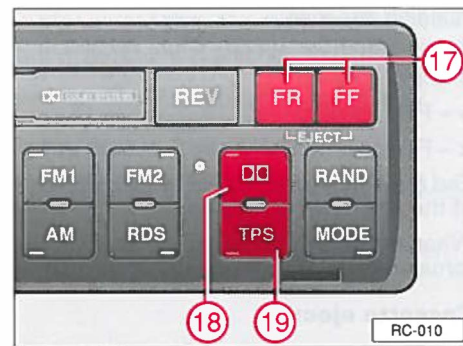

19 – TPS button

Fast forward to the next music selection while playing a cassette.

If you switch on the TPS function (red LED light in the button comes on), you can fast forward to the beginning of the next song, or rewind to the beginning of the current song on a cassette by pressing the fast forward / rewind button 17.

SCAN button 3 Automatic title display selection

Tap the button (red diode light in the button comes on) – all the song titles on the cassette will be shown for eight seconds.

Note

The intervals between selections must be at least 3 seconds.

If the intervals are too short or if extremely soft passages are contained in individual sections of music, the TPS and the SCAN function may not operate properly.

By tapping the button again, the SCAN process can be stopped and the title of the cassette that was just shown can be heard.

Tips for operating cassette player

The radio has automatic tape type switching. For optimum reproduction, we recommend "chromium dioxide" and / or "metal" cassettes.

To ensure troublefree cassette play, use only cassettes made by a well-known manufacturer.

If a pre-recorded cassette shows signs of defect, it is advisable to copy it onto a cassette made by a well-known manufacturer.

To prevent defects caused by the tapes themselves, it is recommended to use tapes with a recording time of less than 90 minutes. Sixty minute cassettes (C60) are well suited for use.

Do not affix any stickers or additional labels to the casing of the cassette.

Such stickers may detach as a result of the heat produced when the cassette is played and cause operating problems.

Never leave cassettes in the car for long periods when they are exposed to very low (less than + 14 °F/ -10 °C) or very high temperatures (above 122 °F/50 °C). Remember that temperatures inside the car can be considerably higher than outside temperatures.

Also prevent direct exposure to sunlight. It is best to store cassettes in a proper storage box with spool detent.

If after many hours of cassette play (about 100 hours depending on the type of tape used), the sound is distorted, it may be because the sound head is soiled with tape particles. These can be cleaned away with a wet cleaning cassette. Use only cleaning cassettes made by a well-known manufacturer, and follow manufacturer's instructions for use.

CD player*



20 – MODE button Selecting

Use the MODE button to select radio, cassette¹⁾ or CD mode.

- The selection occurs in sequence: radio – cassette – CD – radio etc.
- If you press the MODE button while the CD is playing, the unit will switch back to the radio.

¹⁾ Only with fully inserted cassette

- If you press the button twice, the CD will begin playing at the same point where it had been stopped.

If you insert a cassette while the CD is playing, the unit will automatically switch over to the cassette mode.

CD selection

- Tap the MODE button. CD operation is selected.
- Each individual CD in the magazine can be selected by briefly pushing the buttons (radio station buttons 1 – 6).

The CD currently loaded will be shown in the display – CD1 to CD6.

If no CD's are loaded, or no magazine is in the changer, "NO CD" appears in the display.



Buttons for fast forward / rewind and cassette eject, track selection buttons CD 17

Fast forward and rewind

- Press and hold fast forward or rewind: fast CD run (audible).

The direction of winding is indicated in the display:

- > – Fast forward
- < – Fast rewind

Release the button to end the fast forwarding or rewinding.

Track selection buttons

- By tapping one of the buttons, the beginning of the current or the next selection on the CD can be selected.
- Tracks are selected directly upward and downward by briefly pressing one of the buttons several times.

The selected track is shown in the radio display "TR 01....., TR 02....., TR 03....." etc.

Note

At extremely warm outside temperatures, a protective switch will protect the CD and the scanning laser. "CD HOT" is shown in the display.

In this case, you cannot play a CD.

As soon as the player has cooled off a little, "CD HOT" goes off. You can now use the CD player again.



21 – RAND button: Random play for CD mode

When this button is briefly pressed, the unit plays the tracks of the CD in random order.

SCAN button 3 Automatic track selection

Tap the button (red LED light in the button comes on) – all tracks available on the CD are displayed for eight seconds.

By tapping the button again, the SCAN can be stopped and the CD title that was just played can be heard again.

Tips for operating CD

To assure a sound reproduction of the highest quality, use only CDs which are clean and free of scratches or any other type of damage.

Do not stick any labels on a CD.

Store compact discs not being used in the case they came in.

Never leave CDs in direct sunshine.

Cleaning your CDs

For routine cleaning, wipe the playing surface with a clean, soft, lintfree cloth from the center of the disc to the outer edge. If the surface is heavily soiled, dampen a clean soft cloth in a solution of mild neutral commercial detergent before cleaning the disc.

To clean CD's, use a soft lint-free rag. Hold the CD even and clean it from the inside out. Use commercial CD cleaning fluids to remove heavy dirt.

Never use fluids such as benzene, paint thinner or record cleaners, otherwise you may damage the CD surface!

Preventive measures for laser units

Laser devices are divided into safety classes 1 – 4.

Your Audi CD changer corresponds to Safety Class 1.

The laser used in Class 1 is so low and so well shielded, no danger exists with proper usage.

Note

Do not open the cabinet. The unit does not contain any components that can be maintained by the user. For safety reasons please have the unit maintained by qualified service technicians.

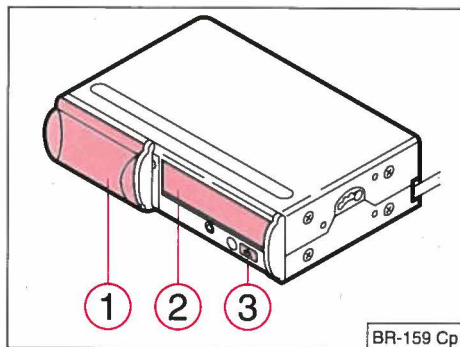
**CD changer**

As a rule, the CD changer and magazine are installed in the luggage compartment of most vehicles. In other models, they may be installed in a compartment in the rear side trim or behind the driver seat. Please refer to your Owner's Manual for the exact location.

- 1 – Sliding door to close the CD slot
- 2 – CD magazine slot
- 3 – Cartridge ejection button

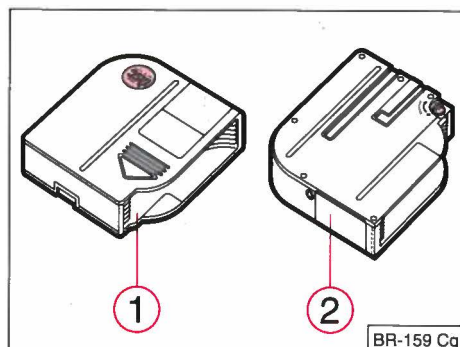
**CD Magazine**

- 1 – Upper side
- 2 – Lower side

Notes

Use only CD magazines approved for use in your Audi.

- Use only CD magazines approved for use in your Audi.
- If there is no magazine in the CD changer, "NO CD" appears in the matrix display ¹⁴ during CD operation.

Removing the magazine

You can remove the CD magazine even with the radio turned off.

- Slide the changer door open.
- Press the Cartridge eject button/ The magazine automatically comes out.
- Remove the magazine.

Inserting the magazine

● With the cover open, slide the magazine all the way in with the inscription "disk" on top.

While doing this, the arrow on the magazine must point towards the magazine slot.

After inserting the magazine, you will hear a "working noise" from the CD changer. The device is simply counting how many CD's are in the changer.

- Close the changer door.

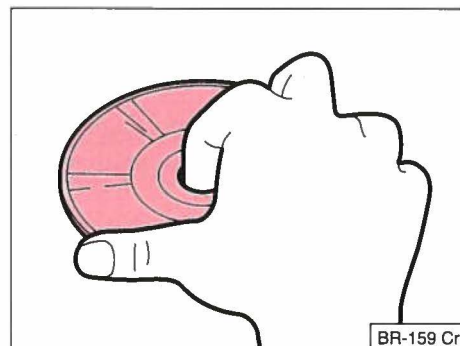
**Loading the magazine with CDs**

- Hold the CD with the printed side facing up and grasping it by the hole and outer edge.

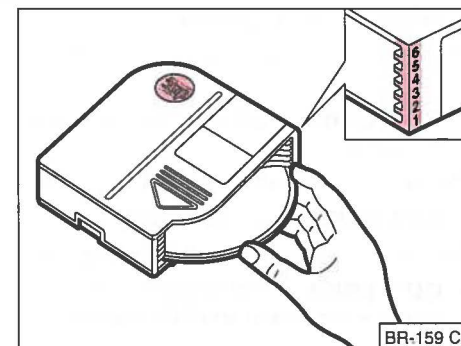

- Hold the magazine with "disk" facing upward.
- Insert the CD's one at a time (printed side facing up) into the magazine until they "click" into place.

Make sure you pay attention to the CD sequence on the right side of the magazine.

Notes

Always close the sliding cover after inserting the magazine to protect your CD changer from dirt and dust.

The magazine hold six standard CD's. Do not use any other type of CD (so called "Shape CD's").

To prevent changer malfunctions, never use a CD protective film or stabilizer (obtained commercially as a CD accessory).

If a magazine slot is empty, "NO CD" will appear in the matrix display during CD operation if that magazine slot is selected.

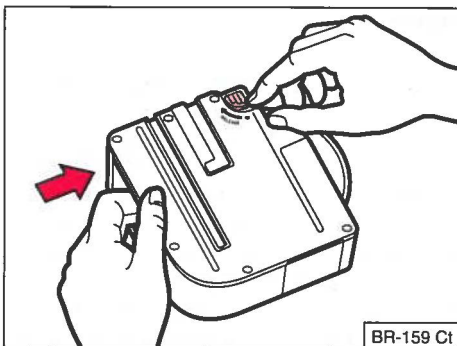

Removing CDs from the magazine

- Turn the magazine over and hold it with the CD release lever up.
- Hold the release lever against the spring force.
- Press the CD's out through the opening in the back of the magazine.

Don't let the CD's drop!

- Take the CD's out of the magazine.

Malfunction displays

The following malfunctions can be displayed:

- **CD1 ERR1** = CD dirty or improperly installed.
The next CD will automatically be selected.
- **CD1 ERR2** = CD has scratches.
The next CD will automatically be selected.
- **CD1 ERR3** = Malfunction in the mechanical system of the CD changer.

- In this case, press the button for magazine eject – see page 18.
- Check the CD's for damage and / or correct installation position.
- Insert the magazine once again.

Try the CD player again. If it still malfunctions, contact your authorized Audi Dealer.

Anti-theft coding

The anti-theft coding will electronically prevent unauthorized persons from operating the unit if it has been removed from the vehicle.

The electronic lock-up is operational, if:

- the radio is disconnected from the vehicle current supply
- the battery is disconnected
- the electric fuse for the radio is blown

the word "SAFE" will appear in the display when the radio is switched on. The unit will only work again if the **correct** code has been entered.

This code number and the radio serial number are on the "Radio Card" next to the table of contents at the beginning of this instruction booklet.

It is very important that you detach this card and keep it in a safe place – never keep it in the vehicle. This is the only way to ensure that the radio is useless to thieves.

Cancelling the electronic lock-up

If for any reason your radio has been electronically locked-up – for example if the battery has been disconnected or the radio fuse has blown – the word "SAFE" will appear in the display when the radio is switched on.

To cancel the electronic lock-up, you must enter the **correct** code number.

It is essential that the following steps be carried out in the correct order:

- Turn on radio – the word "SAFE" appears in the display.
- Press the FM 2 and RDS buttons **simultaneously** and hold them down until "1000" lights up in the display. **Release buttons. Do not, under any circumstances, continue holding them down or press them once again. This would cause the radio to consider the number "1000" to be the input code number.**

Use stations buttons 1 – 4 to enter the code number on your Radio Card. Use button 1 to enter the first digit of the code number, button 2 to enter the second digit, and so on. Station buttons 5 and 6 cannot be used.

- Once the code is shown in the display, press the FM 2 and RDS buttons again simultaneously and hold them down until the word "SAFE" appears in the display. Release buttons. Soon afterwards, a frequency will be displayed.

The radio can now be used again.

Incorrect code number

If an incorrect code number is entered inadvertently when cancelling the electronic lock, the word "SAFE" appears in the display – first flashing and then continuously.

You can now repeat the entire canceling procedure **once more**. The number of attempts will be shown in the display.

If an incorrect number is entered once again, your radio will be locked up for approximately one hour. The radio will not play.

After an hour, the radio must stay on and the key must stay in the ignition lock — if the display goes out, then the tests and electronic lock up can be cancelled again and described.

The cycle – two attempts, one hour lock-up – still applies.

Note

If you lose your Radio Card with the Code Number, contact your authorized Audi Dealer.

Care of antenna

The antenna is optimally tuned to the radio and mounted on the vehicle for best reception and lowest interference.

Automatic antennas must also be cleaned regularly and treated with a chrome cleaner to ensure smooth operation.

If the automatic antenna does not retract or extend properly, the telescopic sections must be cleaned. Never **forcibly** push in or pull out the antenna by hand.

No maintenance is required on antennas incorporated in the windshield or roof.

Other advantages of windshield antennas are that they are safe from damage and are subject to no wear whatsoever.

Warranty

Our radio systems are covered by the same warranty conditions that apply to new cars.

If a warranty claim is made during the warranty period, the unit will be repaired free of charge by any Audi retailer – provided that the damage was not caused by improper treatment or attempts to repair it by non-qualified persons, and that the unit has not suffered any external damage.

Exchange service

After expiration of the warranty period, a radio in need of repair can be exchanged at a reasonable price for a completely reconditioned radio in as-new condition covered by an exchange-part warranty. However, this is only under the condition that the radio has not suffered any external damage and that no unauthorized person has attempted to repair it.

Note

When you place a warranty claim or make use of the exchange service, you must always present your Radio Card with the code and serial numbers to the dealer!

Radio

Anti-theft coding

Radio is electronically locked up if current supply is interrupted. Unit can only be re-used when the correct code number is entered.

Frequency ranges

- AM, FM

Station selection

- In radio mode, automatic selection of last station tuned in before radio switched off (last station memory).
- Twelve station buttons for FM at two levels
- Six station buttons for AM
- Automatic scan function with two sensitivity levels.
- Buttons for manual tuning up-band and down-band
- Microcomputer-controlled stabilization of selected station frequency (PLL Quartz Tuning)

Display

- Frequency, station name (if RDS-signal is transmitted by the radio station)
- RDS
- Cassette player functions
- CD-Changer functions (if installed)
- Waveband
- With corresponding equipment, telephone calls being received are shown in the display with "PHONE" and at the same time, the radio is turned down.
- If the vehicle is equipped with a BOSE SOUND SYSTEM, the display shows "BOSE" (approx. 3 seconds) when the radio is switched on.

Illumination

- Anti-glare illumination of controls from inside
- Brightness adjustable with instrument lighting

Reproduction

- Stereo (radio, cassette and CD)
- Active tone control

- Fader integrated into radio
- Speed sensitive volume control (GALA)
- Multi speaker system

Power output (max.)

Standard system

The radio has 4 line outputs. You can connect the following:

- 2 speakers (front) and 2 active speakers (rear) or
- 4 active speakers or
- any standard commercial amplifier.

A3¹⁾ 80 W + 40 Watt Subwoofer²⁾

A4 80 W

A4 Avant 80 Watt + 40 Watt Subwoofer²⁾

A6 80 W + 60 W Subwoofer²⁾

A6 Avant 80 W + 60 W Subwoofer²⁾

A8¹⁾ 6 x 20 Watt

TT Coupé³⁾ 4 x 20 Watt

TT Roadster³⁾ 4 x 20 Watt + 40 Watt Subwoofer²⁾

¹⁾ not available in USA and Canada

²⁾ active speaker

³⁾ not available at time of printing

BOSE Sound System (overall power)

The radio has 4 line outputs; a BOSE amplifier is connected to these which controls the sound adjustment.

- A3¹⁾ 220 W
- A4 210 W
- A4 Avant 170 Watt
- A6 250 W
- A6 Avant 250 W
- A8 220 W
- TT Coupé²⁾ 175 Watt
- TT Roadster²⁾ 190 Watt

Connecting options

- Electronic antenna
- CD Changer
- NF-muting (phone)

Interference suppression

The automatic interference suppression in the radio largely eliminates interference in the FM waveband.

Specially tuned noise suppressors eliminate nearly all interference pulses emanating from the engine or other parts of the electrical system, such as heater fan, windshield wipers, radiator fan etc.

Cassette player

- Wear-resistant, high performance sound head
- Automatic tape type recognition
- Button for fast forward / reverse
- Electric motor for cassette eject
- Automatic cassette track change at end of tape (auto reverse)

¹⁾ not available in USA and Canada
²⁾ not available at time of printing

CD Changer*

Technical data

The CD changer is "remote control" via the radio.

Changer magazine for 6 CD's with motor eject.

Frequency range:

5 – 20000 Hz (+/- 1 dB)

Noise voltage range:

96 dB

CD total harmonic distortion:

0,006 % (bei 1 kHz)

Synchronizing fluctuations:

Cannot be measured

D/A converter:

MASH 1 Bit

Scanning system:

Astigma 1 beam

Light source:

Semiconductor laser (wave length 780 nm)

What does it mean?

- When playing, the cassette player changes to a different side.

Cause

Cassette does not run smoothly.

Remedy

Fast forward or rewind the cassette.

- The radio station set on the station button does not come on when selected.

Cause

The radio station stored cannot be receiving this area.

Remedy

Assign a new radio station to this button.

A

AM button	7
Anti-theft coding	3, 20, 23
Automatic interference suppression	24
Autoreverse	13

B

Balance control	6
Bass control	7

C

Care of antenna	22
Cassette mode	
– Playing	12
– Title scan function	14
Cassette player	24
Cassette slot	12
Casting of the cassette	14
CD changer	18
CD magazine	18

CD mode

– Loading the CD magazine	19
– Malfunction displays	20
– Mode selection	15
– Random play	16
– Removing CDs	20
– Title scan function	17

CD selection	15
Cleaning cassettes	15
Code number	3, 20, 21
Coding	3, 20, 23
Connecting options	24

D

Display	10, 23
Dolby	13

E

Electronic lock-up	21
Emergency announcements	9
Exchange service	22

F

Fader control	6
FM 1 button	7
FM 2 button	7
Frequency ranges	23

G

GALA	10
------------	----

I

Illumination	23
Interference suppression	24

M

Manual tuning	10
Mode selection	4, 12, 15

N

Noise reduction	12
Noise suppressors	24

O

On/Off knob 6

P

PI-Code 9

Power output 23

PS-Code 9

PTY 31 9

R

Radio Card 3, 20

Radio code number 3

RDS 8

- Function 9

- General information 9

- Storing RDS-stations 8

Reproduction 23

S

Serial number 3, 20

Sound head 15

Speed sensitive volume control .. 10

Station search 9

Storing buttons 4

T

Theft coding 20, 23

Title scan function 14, 17

TPS 14

Treble control 7

Troubleshooting 25

V

Volume control 6

W

Warranty 22

It has always been Audi's policy to continuously improve its products. Audi, therefore, reserves the right to make changes in design and specifications, and to make additions or improvements in its products, without incurring any obligation to install them on products previously manufactured.

Text, illustrations and specifications in this manual are based on information available at the time of printing.

All rights reserved. May not be reproduced or translated in whole or in part without the written consent of AUDI AG. Specifications are subject to change without notice.

Printed in Germany



Printed on environmentally friendly paper (bleached without chlorine, recyclable).

© 1998 AUDI AG

Concert Sound System
Alle Audi Modelle
Nordamerika
englisch 10.98
991.566.450.21